

Interface®

MADE FOR SENIOR LIVING



INTERFACE SENIOR LIVING BROCHURE

CARPET TILE | LVT



MADE FOR



ARCARE WARNERS BAY,
NSW, AUSTRALIA

The lifestyles of seniors are evolving, and so are the spaces they call home. At Interface, we design flooring that combines style and function to create environments where residents feel connected, comfortable, and cared for.

Whether you're bridging healthcare and residential settings or catering to active residents with a high-end lifestyle experience, our soft and resilient flooring supports your community and care needs.

Make an impression, create homelike comfort and support health and safety with design flexibility and performance that help residents live well.

CONNECTION AND CARE

CAN A FLOOR BE MORE THAN A FLOOR?

INTERFACE PRODUCTS STAND UP TO THE UNIQUE DEMANDS OF SENIOR LIVING ENVIRONMENTS, AND OUR FLOORING SOLUTIONS OFFER WIDE-RANGING BENEFITS.



MARINE VIEWS COTTESLOE,
PERTH, AUSTRALIA



MADE FOR WELLNESS AND SAFETY

- Promote positive emotional and physiological reactions with colour, pattern and subtle variations that mimic nature and support biophilic design.
- Increase traction and stability with slip-resistant, ergonomic surfaces and no transition strips, minimising fall risks and cushioning impacts if falls occur.
- Reduce stress and create quieter, restful multi-resident spaces with superior sound absorption.

MADE FOR EASY OWNERSHIP

- Simplify maintenance with durable, easy-to-clean flooring.
- Repair and replace quickly without disrupting day-to-day operations.
- We can provide training and develop a maintenance plan to help extend the lifespan of your flooring.
- Unlock ultimate hygiene control, durability, and ease of maintenance with System ModuShield™ - our installation system designed to pair with 1m x 1m carpet tiles, creating an impermeable barrier for your floor.

MADE FOR REDUCING YOUR ENVIRONMENTAL IMPACT

- Lower your overall carbon footprint while supporting a healthier, more sustainable environment.
- Reduce waste with products made to last and designed for ReEntry®, our reuse and recycling programme that gives your used carpet tiles and LVT new purpose.
- When you choose Interface flooring, you're choosing Australian-manufactured carpet tiles, designed specifically for Australian environments.

YOUR DESIGN PARTNER

WE MAKE FINDING DESIGN SOLUTIONS EASIER WITH INTERFACE DESIGN STUDIO

Our expert designers know Interface products inside and out—and our services are complimentary. From concept to completion, we work closely with you to create distinct designs that meet your vision and budget, no matter how large or small the project. Our scaled floor plans calculate overall waste and serve as an installation guide for the flooring contractor. Plus, they include the embodied carbon calculation, making it easier to design with carbon footprint in mind.

From shared spaces to personal rooms, our integrated system of flooring solutions works seamlessly in virtually any senior living facility. Let us bring your vision to life with products that stand up and stand out across your facility. Contact your Account Manager to get started.

 [CLICK HERE TO LEARN MORE](#)

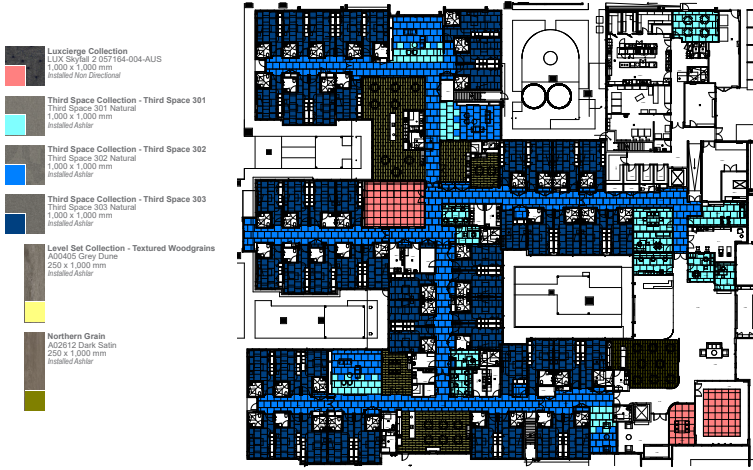

TECHNICAL SUPPORT

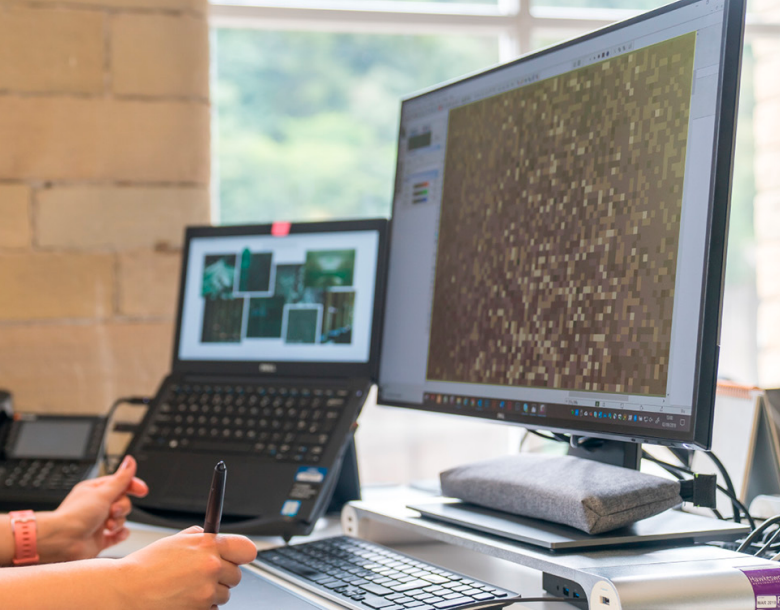

YOU NEED MORE THAN A FLOORING VENDOR — YOU NEED A PARTNER

As your single-source provider, we support your project every step of the way, from design to post-installation, for the life of the product. Consulting with you, we can help create a maintenance plan that delivers a greater return on investment and a lower total cost of ownership.

Let us be your trusted senior living flooring advisor, allowing you to make the most of your budget and create spaces that are Made for More™.



CASE STUDY

ARCARE WARNERS BAY

Location	Arcare Warners Bay, NSW
Project Requirements	Leverage the power of design to give residents a serene, safe, and healthy home. Flooring sets the foundation, balancing the luxury of a coastal retreat with the high function needed for a commercial aged care facility.
Carpet Tile Products	Urban Retreat, UR303 Near & Far, NF401 Upon Common Ground, Shallows and Sandbank
LVT Products	Level Set Textured Woodgrains
Architect/ Designer	Lily Vaughan, Head of Interior Design, Arcare

 [CLICK HERE TO LEARN MORE](#)



CASE STUDY

GREENWAY VIEWS

Location	Greenway Views Seniors' Living Village, ACT
Project Requirements	Create an environment that connects place, community, and care to offer senior residents a better quality of life centred around wellbeing and homeliness.
Carpet Tile Products	World Woven
LVT Products	Level Set Textured Woodgrains and Textured Stones
Architect/ Designer	Gray Puksand

 [CLICK HERE TO LEARN MORE](#)



CARPET TILE

EVERYTHING YOU LOVE ABOUT SOFT FLOORING
BUT WITH THE FLEXIBILITY OF TILE.

- GlasBac® and CushionBacRE™ backing provide ergonomic surfaces for residents and staff without compromising stability, supporting rolling devices.
- Superior sound absorption over most hard surfaces, with cushion backing further enhancing acoustic performance - ideal for creating peaceful, quiet environments.
- Durable premium recycled content nylon fibres that minimise wear in high-traffic areas.
- Quick installation and easy replacement with our glue-free TacTiles™ installation system.
- Intersept®, our EPA registered proprietary antimicrobial treatment, is permanently incorporated into the backing to protect against mould growth and odour—even at the seams.

[CLICK HERE TO LEARN MORE](#)



AVEO NEWSTEAD GASWORKS,
BRISBANE, AUSTRALIA

LUXURY VINYL TILE

BRING YOUR VISION TO LIFE WITH OUR
DURABLE 4.5 MM SOUND CHOICE™ LVT.

4.5 mm Sound Choice

- Greater impact sound reduction of 16dB.
- Ceramor+™ coating resists slips, scuffs, and scratches.
- 39% pre-consumer recycled content.
- Can be sustainably recycled through Resiloop, a vinyl flooring recycling programme in Australia to support a closed-loop system.
- Designed as a smart system in the same dimensions and height as our carpet tiles, eliminating the need for transition strips.

[CLICK HERE TO LEARN MORE](#)



GREENWAY VIEWS SENIORS' LIVING VILLAGE,
ACT, AUSTRALIA

WE'RE *'all in'*

ON SOLVING THE CLIMATE CRISIS

INTERFACE IS COMMITTED TO CREATING HEALTHIER ENVIRONMENTS FOR SENIOR LIVING FACILITIES WHILE MEETING THE URGENCY OF THE CLIMATE CRISIS.



Carbon negative carpet tile, launched in 2020, changed everything for Interface. We now know it's possible to store more carbon than we emit.

So we are challenging ourselves and others to become carbon negative enterprise-wide, without offsets. We've set an incredibly bold and ambitious goal to be carbon negative by 2040, with science based targets set as a 2030 stepping stone on our path.

But our plan is simple. We will continue to avoid, reduce and store as much carbon as we can. And we will inspire others so that we can create a ripple effect for an even greater positive impact.

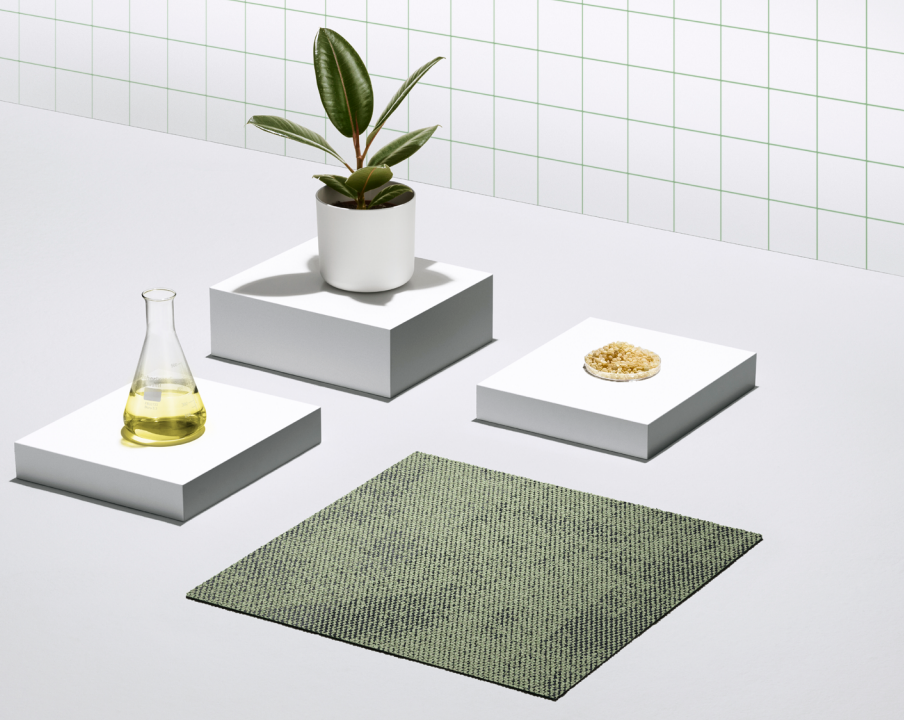

*let's plan for a better
world, together*

[CLICK TO LEARN HOW WERE 'ALL-IN'](#)

Cover Image: Arcare Warners Bay, NSW, Australia



www.interface.com

Australia

Interface Australia
local toll free: 1800 804 361

India

Interface India
tel: +91 76249 17934

South East Asia

Interface Asia
tel: +65 6478 1510

South Korea

Interface South Korea
tel: +82 2 555 1734

Japan

Interface Japan
tel: +81(0)3-6892-5513

Beijing

Interface China
tel: +86 10 6590 7810

Hong Kong

Interface China
tel: +852 2802 0838

Shanghai

Interface China
tel: +86 21 6340 3868