

Interface *Hospitality*

HOME 2 SUITES BY HILTON

Why **Interface® Hospitality**?

Interface Hospitality is a **Hilton Worldwide** approved supplier of carpet tile and LVT. We are currently on the following prototypes:

- Hampton Inn
- Hilton Garden Inn
- Home 2 Suites
- Tru By Hilton

1. **8 WEEKS OR LESS LEAD TIME** for anything not already in stock.
2. **NO ROLL SIZES OR WIDTHS** to deal with. We come in boxes!
3. What about **UNIT COST?** We can compare the real cost of tile vs. broadloom for each project and show you the true savings.
4. **15 YEAR WARRANTY.** Say no more.
5. **SELECTIVE REPLACEMENT** means little to no disruptions to hotel operations.
6. **INTERSEPT®** antimicrobial protection. Keepin' it clean.
7. **PROTEKT²** stain resistant technology. Keepin' it real clean!
8. Greater **EASE OF HANDLING**, less liability related to mis-cutting of broadloom.
9. Order and installation is a breeze with our **ESTIMATES, SEAMING DIAGRAMS, AND RENDERINGS.**
10. All of our yarns are **100% SOLUTION-DYED NYLON.**
11. **VARIOUS TILE SIZES** make is easier to design/define spaces and sub-spaces
12. Our **CARPET** and **LVT** work together in seamless integration, with no transition strips.
13. We are **MORE SUSTAINABLE:** All of our products are **EPD** verified
14. Interface Hospitality's **REENTRY® RECLAMATION & RECYCLING** program results in our products having up to 80% recycled content, from returned/used carpet.
15. We are the first global manufacturer to declare that all our products globally including all carpet and luxury vinyl tile (LVT) – are **CARBON NEUTRAL** across their entire product lifecycle.

Why **Interface® Hospitality**?

1. **Lead Time**

If not in stock, our lead times are 6-8 weeks and all products are manufactured in the USA. FOB Union City, Georgia.

2. **No Roll Sizes or Widths**

There are no widths and roll sizes to deal with, which can often lead to hidden costs and unused material.

3. **Unit Cost**

The unit cost is only part of the evaluation when comparing carpet tile to broadloom for your hotel. Waste is a big consideration with total project cost. We can develop project specific CO's to compare total project cost for your individual property.

4. **15 Year Warranty**

All Interface Hospitality products are hard wearing, provide lasting protection against excessive surface wear, edge ravel, backing separation, shrinking, stretching and permanent soiling and staining.

5. **Selective Replacement**

Whether you're replacing a single guest room, a corridor, or an entire hotel, you can do so without disruption. Interface Hospitality's selective replacement enables old flooring to be replaced quickly and efficiently any day of the week. Your carpet replacement costs can be cut by up to 50%.

6. **Intersept®**

Mold Protection no matter what's spilled on the floor, our proprietary antimicrobial preservative, Intersept®, protects our modular carpet against the growth of odor-causing bacteria guaranteed. With proper maintenance, Intersept treated carpet safely and effectively inhibits the growth of mold and other bacteria so your floors are always fresh. All Interface carpet is standard with Intersept.

7. **Protekt²**

Because stain resist technology - Protekt² - is built into Interface carpet tiles, a topical stain resist treatment is not necessary. The additional polymer is included when nylon is manufactured so it permanently increases stain resistance. We conducted stain tests on our products and compared them to products with a topical treatment. The results? Our uncoated fibers performed just as well as the treated ones. Additionally, the fluorinated chemicals traditionally used in stain resist treatments, when they do wash off, persist in the environment for thousands of years. With Protekt², you get permanent stain resistance, not permanent pollution.

8. **Ease of Handling**

Carpet tile offers greater ease of handling, and installers have less liability related to possible mis-cutting of broadloom.

9. **Installation**

Order and installation is a breeze with our estimates, seaming diagrams and renderings.

10. **100% Solution-dyed Nylon**

Vibrant color that does not fade. All Interface Hospitality carpet tiles are made from durable, stain resistant, 100% solution dyed nylon. Offering superior color fastness and a wide array of colors and textures, solution dyed nylon is less harmful to the environment, using no water or toxic chemicals in the manufacturing process.

11. **Various Sizes**

Using, 50cm, 1m, 25cm x 1m and 50cm x 1m tiles allows for optimal pattern repeats, asymmetrical and symmetrical designs and color use. It also allows design to define Spaces / Nesting within larger areas.

12. **Integrated System**

Interface modular tiles span a wide selection of designs that offer pattern, color and texture options for a myriad of flooring needs. Tiles come in a variety of shape and size modules that work seamlessly and interchangeably with each other. This compatibility allows for holistic flooring solutions with expansive design flexibility.

13. **Sustainable Choice**

Environmental Responsibility. Interface Hospitality was the industry's first to earn an EPD (Environmental Product Declaration), which evaluates consistent factors based on full lifecycle assessment (LCA). We now have published EPDs for 99% of our products globally. In addition, all of our products with GlasBac®, GlasBacRE and NexStep® backings meet NSF/ANSI 140 Sustainable Carpet Assessment Standard (SCAS) for carpet.

14. **Carpet Recycling Program: ReEntry®**

Recyclable is Now a Reality. Through our ReEntry program and partnerships with our fiber suppliers and recycling centers throughout North America, separated Type 6 and 6,6 nylon are recycled into new 6 and 6,6 nylon, while separated GlasBac® and similar competitor backings are recycled into GlasBac®RE non-virgin PVC backing using our Cool Blue™ technology. The result? Products with up to 80% total recycled content, including as much as 35% post-consumer content.

15. **Carbon Neutral**

We are the first global manufacturer to declare that all our products globally — including all carpet and luxury vinyl tile (LVT) — are carbon neutral across their entire product lifecycle. We've achieved carbon neutrality by drastically reducing our carbon footprint and addressing the rest of our emissions through carbon offset investments.

16. **Dimensional Stability**

Interface GlasBac® backing has been tested and proven in the marketplace for over 30 years. Engineered to provide superior dimensional stability, GlasBac® modular carpet tiles will not stretch or shrink when exposed to heat or cold, heavy foot or rolling traffic.

17. **Sound Absorption**

Quiet space is essential when people need to focus and concentrate. Sound absorption is therefore critical when colleagues need to collaborate without becoming a distraction to their neighbors. Interface Hospitality carpets provide high sound absorption and insulation.

Chelsea Prototype Order Information

CONTACT: Sofia Davila sofia.davila@interface.com | 347.633.0577 or your local Account Executive



Reception Desk Product	Hilton Spec. #	Sample #	Color #	Size	Installation
Exposed	(A) CP-01	256794-189	188435	50cm x 50cm	Non Directional
Boardroom Product	Hilton Spec. #	Sample #	Color #	Size	Installation
Exposed	(A) CP-02	256794-189	188435	50cm x 50cm	Non Directional
Installation Specifications	Description				
XL2000 Plus	Adhesive				

RECEPTION DESK INSTALLATION PLAN

Interface Hospitality

All quantities are estimates only and are based on plans provided. Site measurements and field verifications are recommended to ensure accuracy. These quantities are not intended to be used for material ordering purposes. Since waste factors may vary by installer, actual ordering quantities are the responsibility of your flooring contractor.

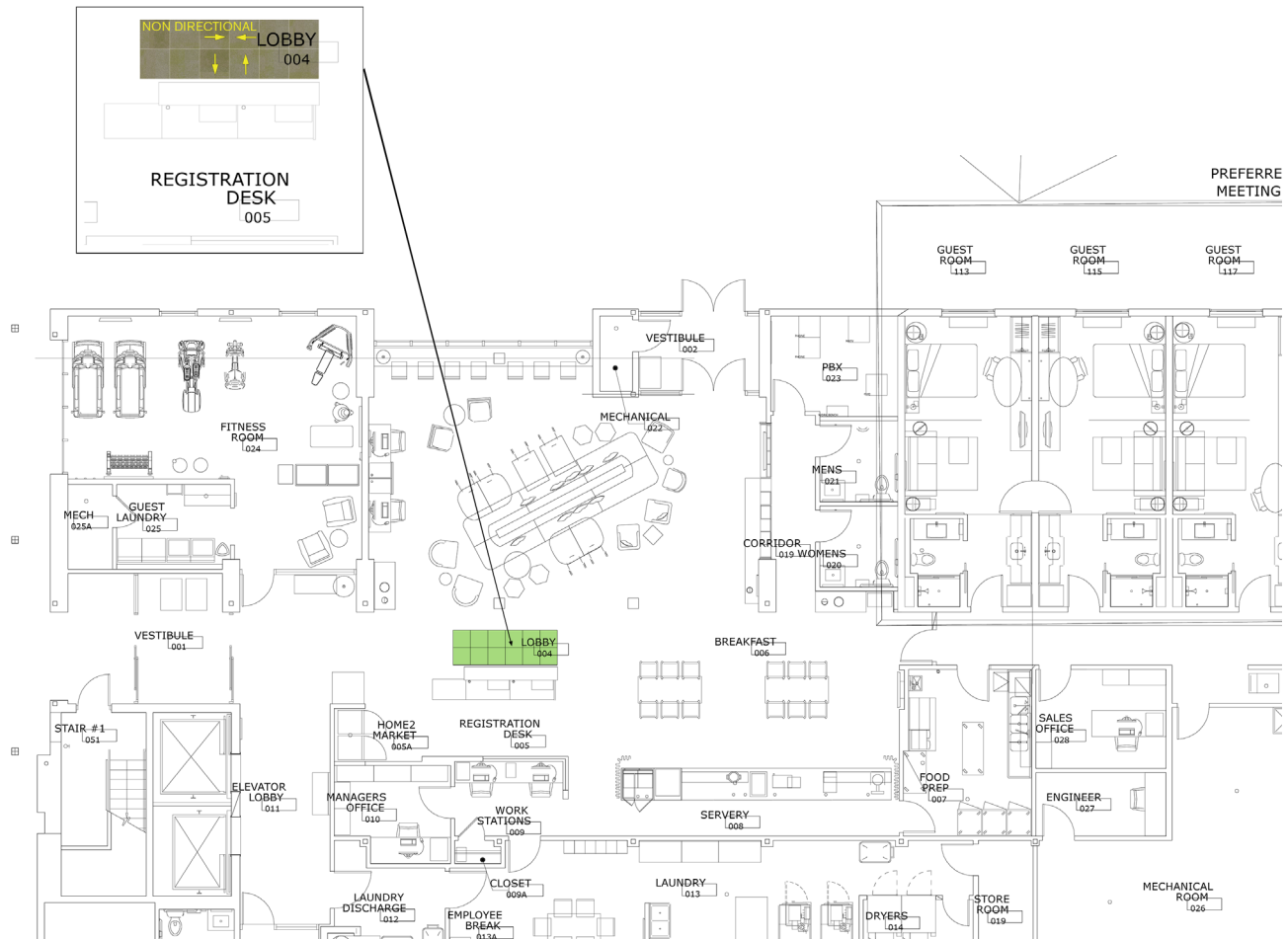

LEGEND

A

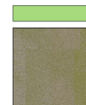

PRODUCT: Exposed
COLOR: 188435
SIZE: 50cm
INSTALLED: Non Directional

Chelsea Prototype Order Information

CONTACT: Sofia Davila sofia.davila@interface.com | 347.633.0577 or your local Account Executive

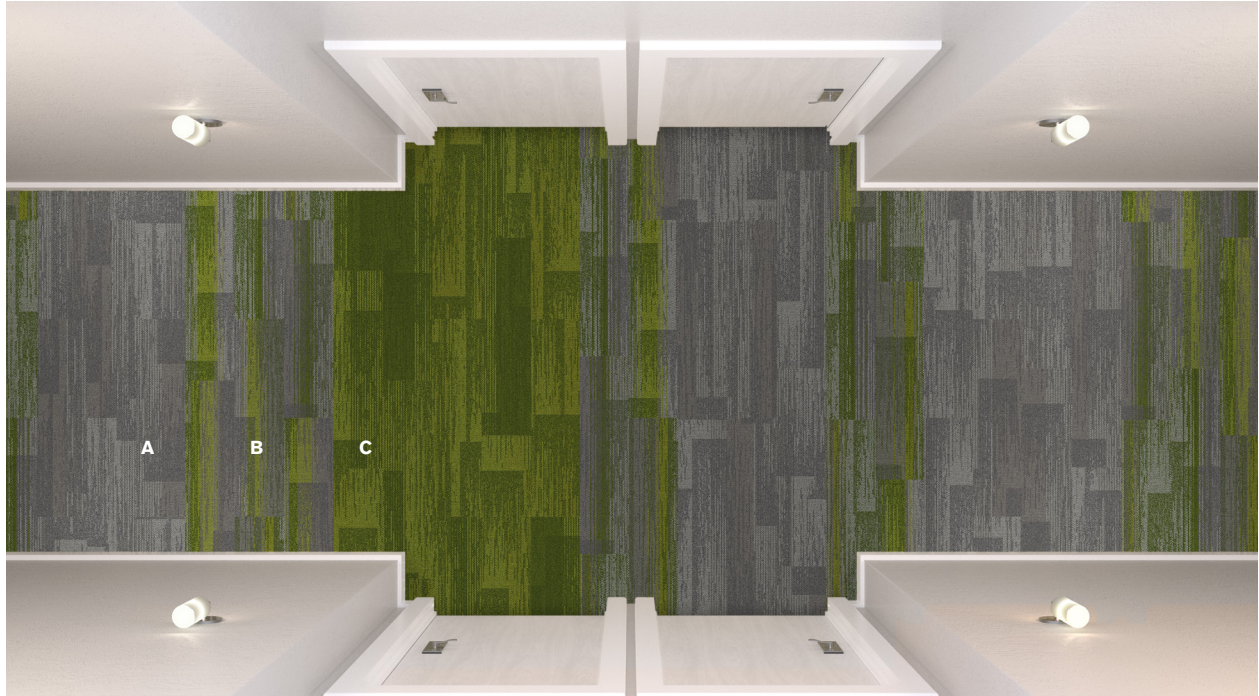

Corridor Products	Hilton Spec. #	Sample #	Color #	Size	Installation
AE311 A	(A) CP-02B	256794-158	188431	50cm x 50cm	Pattern by Tile
AE315 B	(A) CP-02A	256794-155	188429	50cm x 50cm	Pattern by Tile
AE311 C	(A) CP-02C	256794-161	188432	50cm x 50cm	Pattern by Tile
Viva Colores 4" Base	(A) CB-01		106048 Ostra	4" x 25' Rolls	
Stair Products	Hilton Spec. #	Sample #	Color #	Backing	Description
AE315	(A) CP-07	256794-155	188429	Glasbac	Stair Landaing
AE315	(A) CP-06	256794-155	188429	Unbacked Sheet Goods	Stair Carpet
Installation Specifications	Description				
XL2000 Plus	Adhesive				

CORRIDOR INSTALLATION PLAN

Interface Hospitality

All quantities are estimates only and are based on plans provided. Site measurements and field verifications are recommended to ensure accuracy. These quantities are not intended to be used for material ordering purposes. Since waste factors may vary by installer, actual ordering quantities are the responsibility of your flooring contractor.



Chelsea Prototype Order Information

CONTACT: Sofia Davila sofia.davila@interface.com | 347.633.0577 or your local Account Executive



Guest Room Product	Hilton Spec. #	Sample#	Color #	Size	Installation
Platform A	(A) CP-03		9332 Soapstone	50cm x 50cm	Brick
Custom B	(A) CP-04	256794-176	188274	50cm x 50cm	Brick
Installation Specifications	Description				
XL2000 Plus	Adhesive				

GUEST ROOM INSTALLATION PLAN

Interface Hospitality

All quantities are estimates only and are based on plans provided. Site measurements and field verifications are recommended to ensure accuracy. These quantities are not intended to be used for material ordering purposes. Since waste factors may vary by installer, actual ordering quantities are the responsibility of your flooring contractor.

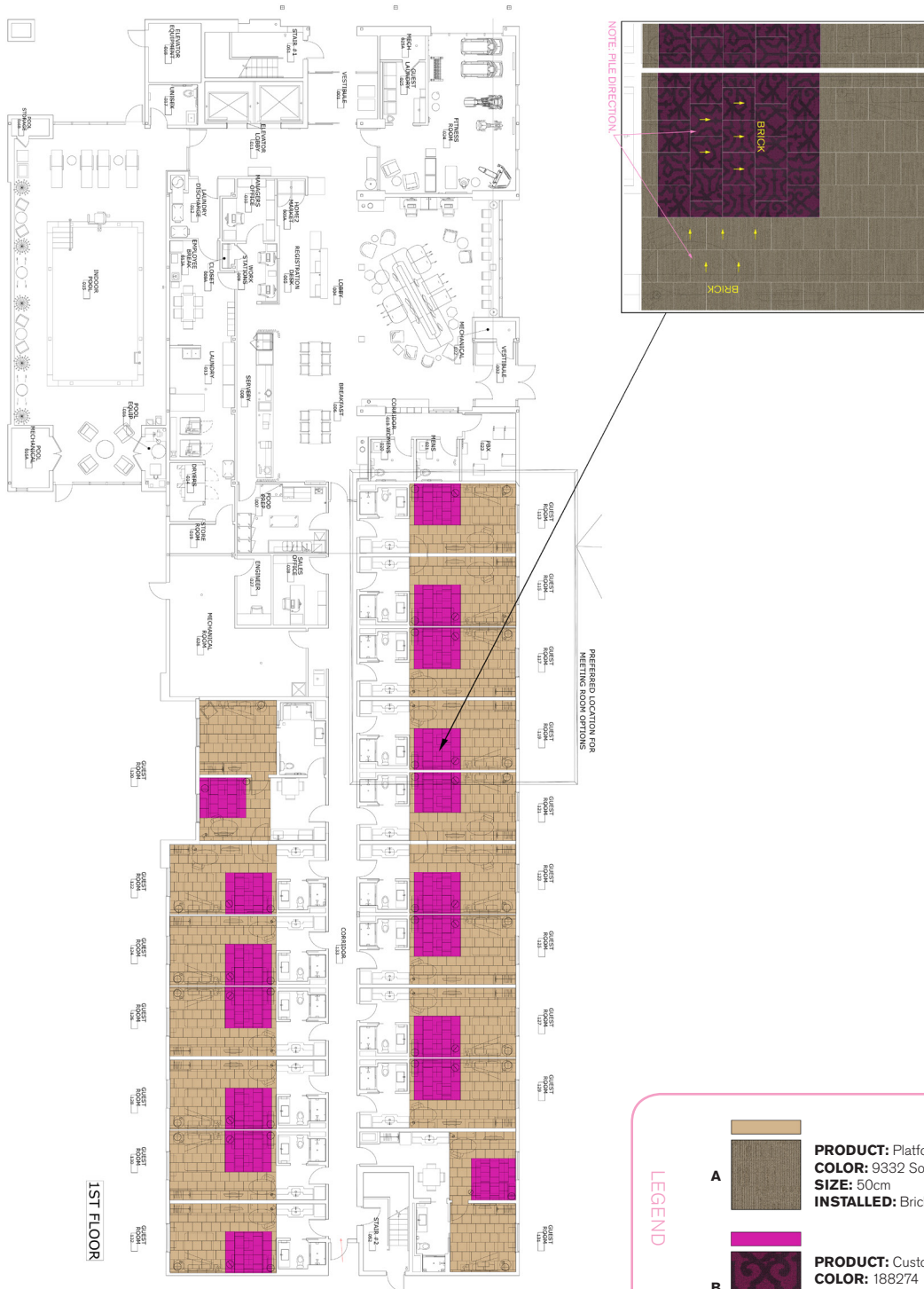

Tribeca Prototype Order Information

CONTACT: Sofia Davila sofia.davila@interface.com | 347.633.0577 or your local Account Executive



Reception Desk Product	Hilton Spec. #	Sample #	Color #	Size	Installation
Exposed	(B) CP-01	256794-152	188434	50cm x 50cm	Non Directional
Boardroom Product	Hilton Spec #	Sample #	Color #	Size	Installation
Exposed	(B) CP-02	256794-152	188434	50cm x 50cm	Non Directional
Installation Specifications	Description				
XL2000 Plus	Adhesive				

RECEPTION DESK INSTALLATION PLAN

Interface Hospitality

All quantities are estimates only and are based on plans provided. Site measurements and field verifications are recommended to ensure accuracy. These quantities are not intended to be used for material ordering purposes. Since waste factors may vary by installer, actual ordering quantities are the responsibility of your flooring contractor.

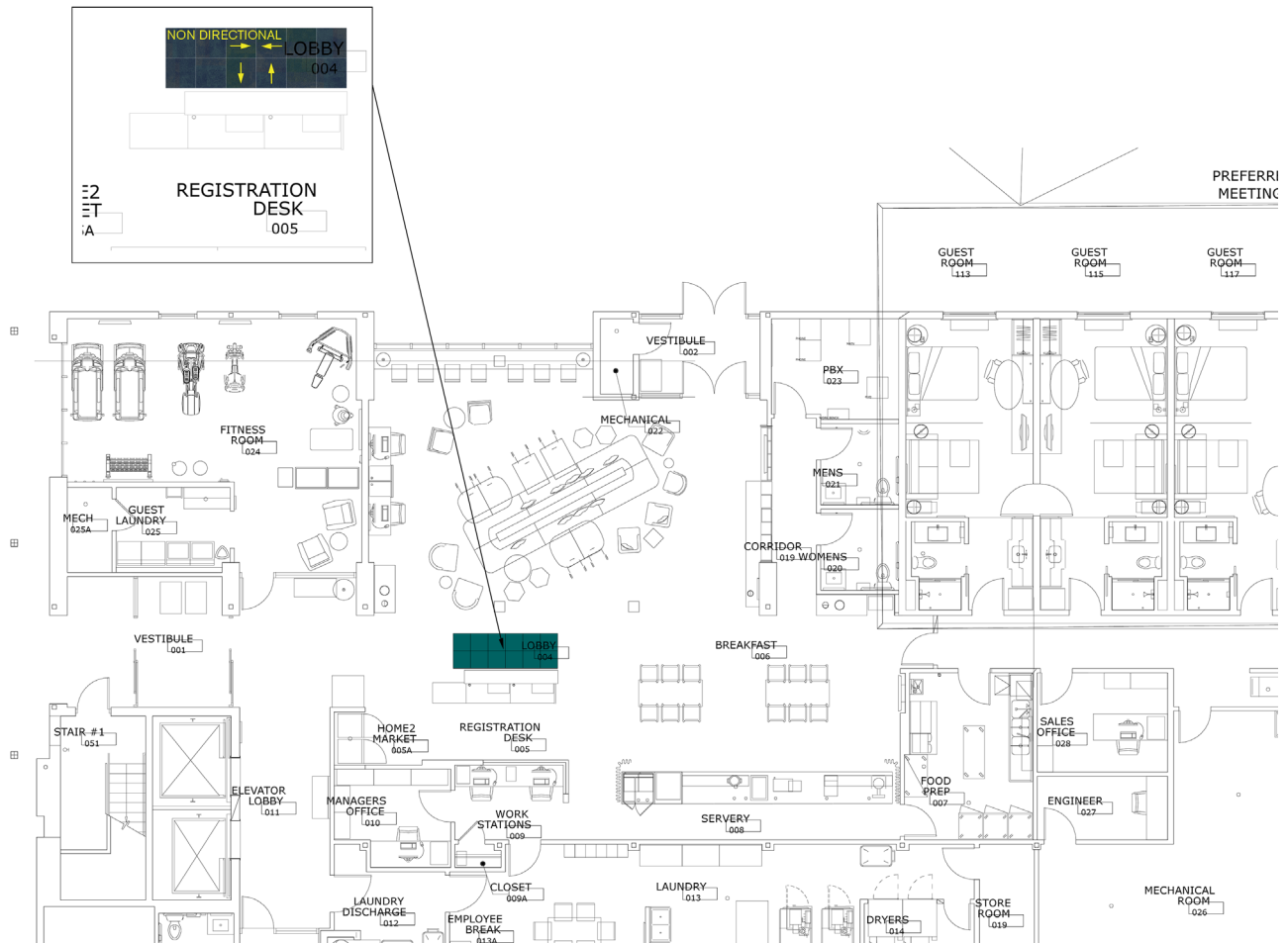

LEGEND

A



PRODUCT: Exposed
COLOR: 188434
SIZE: 50cm
INSTALLED: Non Directional

Tribeca Prototype Order Information

CONTACT: Sofia Davila sofia.davila@interface.com | 347.633.0577 or your local Account Executive

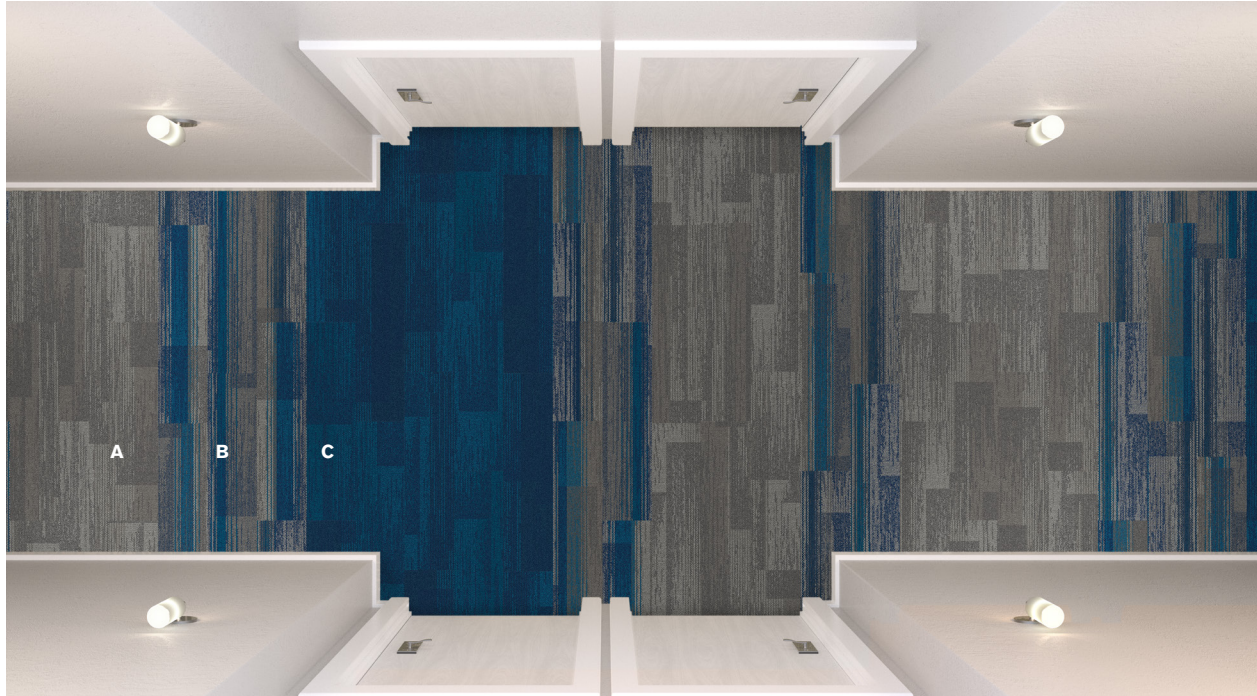

Corridor Products	Hilton Spec. #	Sample #	Color #	Size	Installation
AE311 A	(B) CP-02AB	256794-158	188431	50cm x 50cm	Pattern by Tile
AE315 B	(B) CP-02A	256794-156	188430	50cm x 50cm	Pattern by Tile
AE311 C	(B) CP-02C	256794-164	188433	50cm x 50cm	Pattern by Tile
Viva Colores 4" Base	(B) CB-01		106048 Ostra	4" x 25' Rolls	
Stair Products	Hilton Spec. #	Sample #	Color #	Backing	Description
AE315	(B) CP-07	256794-156	188430	Glasbac	Stair Landing
AE315	(B) CP-06	256794-156	188430	Unbacked Sheet Goods	Stair Carpet
Installation Specifications	Description				
XL2000 Plus	Adhesive				

CORRIDOR INSTALLATION PLAN

Interface Hospitality

All quantities are estimates only and are based on plans provided. Site measurements and field verifications are recommended to ensure accuracy. These quantities are not intended to be used for material ordering purposes. Since waste factors may vary by installer, actual ordering quantities are the responsibility of your flooring contractor.

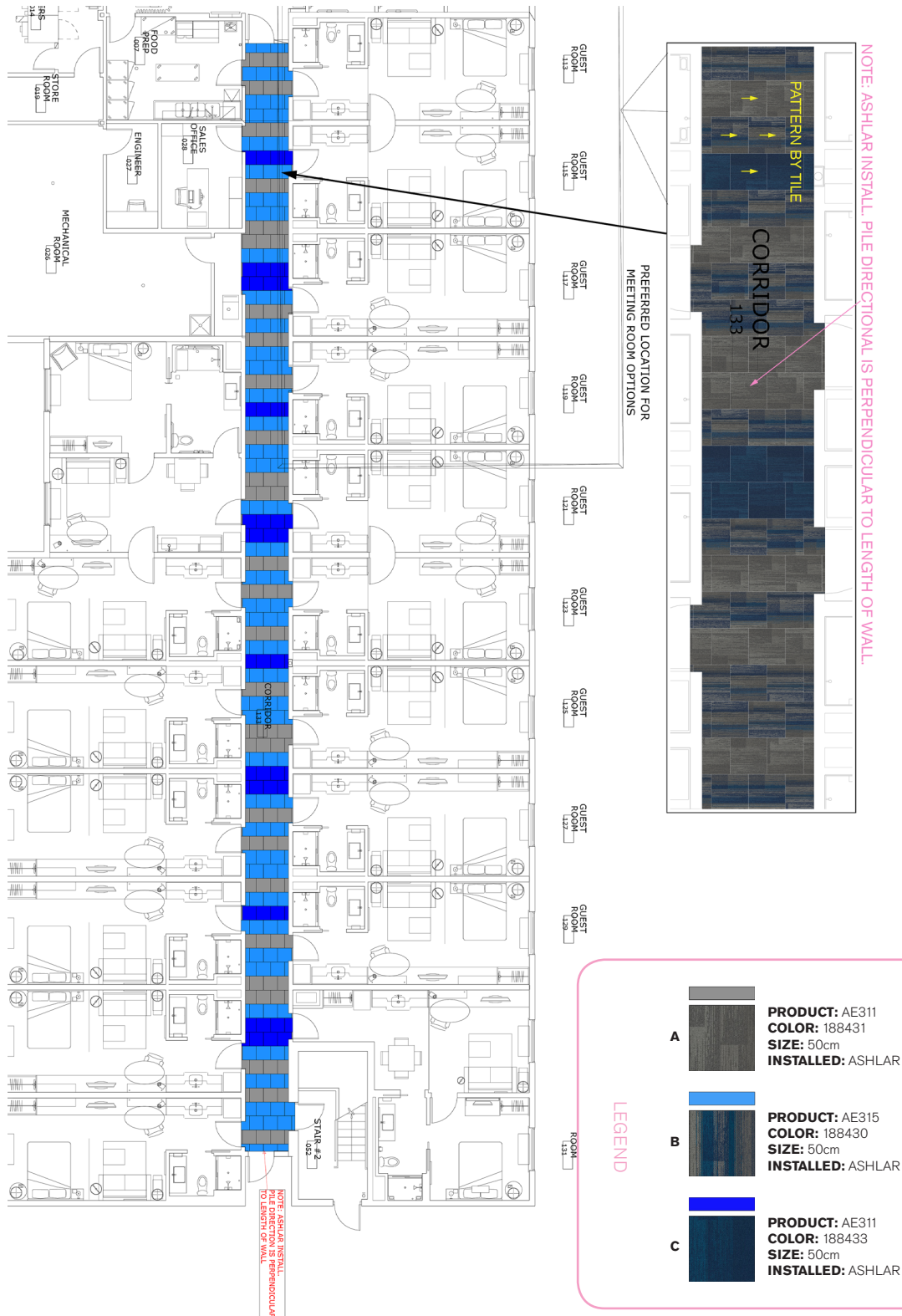

Tribeca Prototype Order Information

CONTACT: Sofia Davila sofia.davila@interface.com | 347.633.0577 or your local Account Executive



Guest Room Product	Hilton Spec. #	Sample#	Color #	Size	Installation
Platform A	(B) CP-03		9332 Soapstone	50cm x 50cm	Brick
Custom B	(B) CP-04	256794-187	188436	50cm x 50cm	Brick
Installation Specifications	Description				
XL2000 Plus	Adhesive				

GUEST ROOM INSTALLATION PLAN

Interface Hospitality

All quantities are estimates only and are based on plans provided. Site measurements and field verifications are recommended to ensure accuracy. These quantities are not intended to be used for material ordering purposes. Since waste factors may vary by installer, actual ordering quantities are the responsibility of your flooring contractor.

