

Interface®

# HOME2 SUITES



## APPROVED PROTOTYPES

Hampton Inn by Hilton  
Hilton Garden Inn  
Home2 Suites  
Tru by Hilton

# WHY INTERFACE HOSPITALITY?

Interface Hospitality is a **HILTON HOTELS** approved supplier of carpet tile and LVT. We are currently approved on the following prototypes:

- Hampton Inn by Hilton
- Hilton Garden Inn
- Home2 Suites
- Tru by Hilton



## SMART, EFFICIENT, AND BUILT TO LAST

### Seamless Installation & Design Flexibility

Interface modular flooring tiles are designed for effortless installation with systems like TacTiles®—our no-glue solution that reduces VOCs and waste. Choose from multiple sizes and patterns to create tailored designs that fit your needs while optimizing material usage.

### Cost Efficiency, Built-In

Reduce hidden costs with modular tiles—no roll sizes, no wasteful cuts, and an average of only 3-4% waste compared to broadloom's 14%. Our selective replacement system minimizes disruption, allowing you to replace flooring in stages and save up to 50% on replacement costs.

### Durability You Can Count On

Every product is backed by a 15-year warranty, combining innovative features like Intersept® mold protection and Protekt2™ stain resistance for unparalleled longevity. With modular carpet, you're investing in a solution that performs and saves in the long run.



## DESIGNED FOR PERFORMANCE AND PEOPLE

### Innovative Fibers for Vibrant, Sustainable Style

All Interface carpet tiles are made from 100% solution-dyed nylon—engineered for vibrant, fade-resistant color without the need for water or harmful chemicals in production.

### The Power of Integrated Systems

Interface tiles span a variety of sizes and textures, enabling endless creative possibilities. Our modular designs seamlessly integrate with LVT for holistic flooring solutions without transition strips, redefining design flexibility.

### Health-Conscious Choices

Our Intersept® treatment guarantees mold protection and uses no halogens, heavy metals, or harmful chemicals. It's EPA-approved for safe use, ensuring healthier spaces for your guests and teams.

## SUSTAINABILITY & END-OF-LIFE SOLUTIONS

### Transparency at Every Step

Sustainability comes standard. With third-party certifications and 99% renewable energy powering our U.S. manufacturing, Interface delivers flooring that's both high-performing and environmentally conscious.

### Recycling Made Simple with ReEntry®

Through ReEntry®, we reclaim and recycle used carpet tiles and Sound Choice™ LVT, keeping valuable materials out of landfills. As North America's only third-party-certified flooring recycling program, we set the benchmark for responsible end-of-life solutions.

### Smarter Installations for a Smaller Footprint

TacTiles® eliminate the need for adhesives with carpet tiles, cutting installation waste by 90%. Combined with modular flooring's reduced waste profile, this innovation ensures your project leaves a lighter environmental footprint.

## CHELSEA RECEPTION & BOARDROOM PROTOTYPE ORDER INFORMATION

Carpet tiles **SAVE APPROXIMATELY 18%-20% IN PRODUCT WASTE** versus broadloom, based on prototype layout.



PRODUCT	ITEM#	COLOR#	SAMPLE#	SIZE	INSTALLATION
<b>Reception</b> Exposed	(A) CP-01	256794-189	188435	50 cm x 50 cm	Non Directional
<b>Boardroom</b> Exposed	(A) CP-02	256794-189	188435	50 cm x 50 cm	Non Directional

INSTALLATION SPECIFICATIONS	DESCRIPTION
XL2000 PLUS Adhesive	Double stick install

# CHELSEA RECEPTION & BOARDROOM INSTALLATION PLAN

All quantities are estimates only and are based on plans provided. Site measurements and field verifications are recommended to ensure accuracy. These quantities are not intended to be used for material ordering purposes. Since waste factors may vary by installer, actual ordering quantities are the responsibility of your flooring contractor.

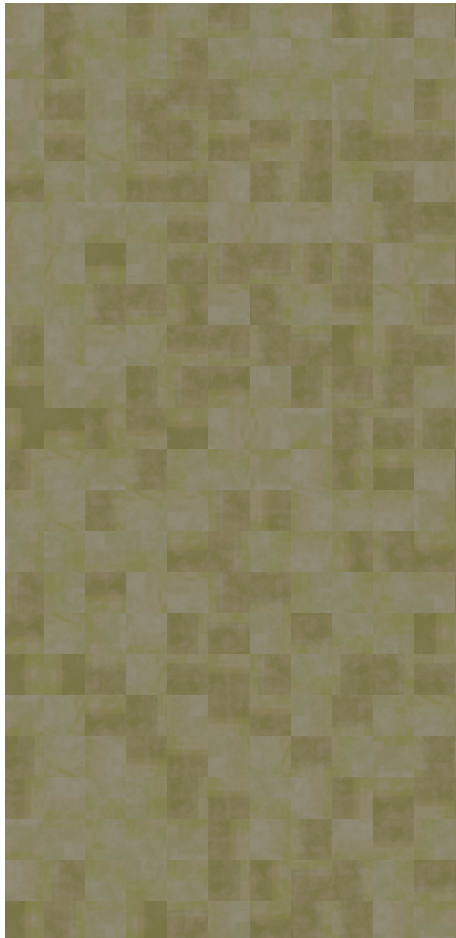

RECEPTION: (A) CP-01



BOARDROOM: (A) CP-02

## LEGEND



**PRODUCT:** Exposed  
**ITEMS:** (A) CP-01 & (A) CP-02  
**SAMPLE/COLOR:** 188435\_256794-189  
**SIZE:** 50 cm x 50 cm  
**INSTALLED:** Non Directional

## CHELSEA CORRIDOR PROTOTYPE ORDER INFORMATION

Carpet tiles **SAVE APPROXIMATELY 18%-20% IN PRODUCT WASTE** versus broadloom, based on prototype layout.



PRODUCT	ITEM#	COLOR#	SAMPLE#	SIZE	INSTALLATION
<b>A</b> AE311	(A) CP-02B	256794-158	188431	50 cm x 50 cm	Ashlar
<b>B</b> AE315	(A) CP-02A	256794-155	188429	50 cm x 50 cm	Ashlar
<b>C</b> AE311	(A) CP-02C	256794-161	188432	50 cm x 50 cm	Ashlar
Viva Coiores 4" Carpet Base	(A) CB-01	106048 Ostra		4" x 25' Rolls	

INSTALLATION SPECIFICATIONS	DESCRIPTION
XL2000 PLUS Adhesive	Double stick install

# CHELSEA CORRIDOR INSTALLATION PLAN

All quantities are estimates only and are based on plans provided. Site measurements and field verifications are recommended to ensure accuracy. These quantities are not intended to be used for material ordering purposes. Since waste factors may vary by installer, actual ordering quantities are the responsibility of your flooring contractor.

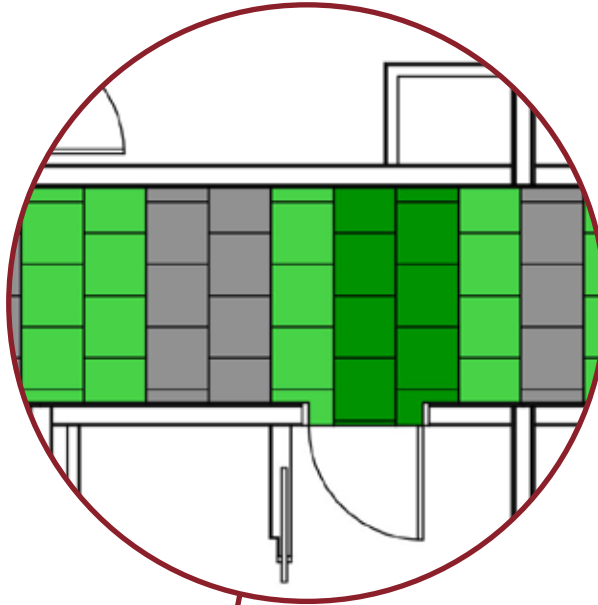

## LEGEND

**A**



**PRODUCT:** AE311  
**ITEM:** (A) CP-02B  
**SAMPLE/COLOR:** 188431\_256794-158  
**SIZE:** 50 cm x 50 cm  
**INSTALLED:** Ashlar

**B**



**PRODUCT:** AE315  
**ITEM:** (A) CP-02A  
**SAMPLE/COLOR:** 188429\_256794-155  
**SIZE:** 50 cm x 50 cm  
**INSTALLED:** Ashlar

**C**



**PRODUCT:** AE311  
**ITEM:** (A) CP-02C  
**SAMPLE/COLOR:** 188432\_256794-161  
**SIZE:** 50 cm x 50 cm  
**INSTALLED:** Ashlar

## CHELSEA GUESTROOM PROTOTYPE ORDER INFORMATION

Carpet tiles **SAVE APPROXIMATELY 18%-20% IN PRODUCT WASTE** versus broadloom, based on prototype layout.



PRODUCT	ITEM#	COLOR#	SAMPLE#	SIZE	INSTALLATION
A Platform	(A) CP-03	9332 Soapstone		50 cm x 50 cm	Brick
B Custom	(A) CP-04	256794-176	188274	50 cm x 50 cm	Brick

INSTALLATION SPECIFICATIONS	DESCRIPTION
XL2000 PLUS Adhesive	Double stick install

## CHELSEA GUESTROOM INSTALLATION PLAN

All quantities are estimates only and are based on plans provided. Site measurements and field verifications are recommended to ensure accuracy. These quantities are not intended to be used for material ordering purposes. Since waste factors may vary by installer, actual ordering quantities are the responsibility of your flooring contractor.

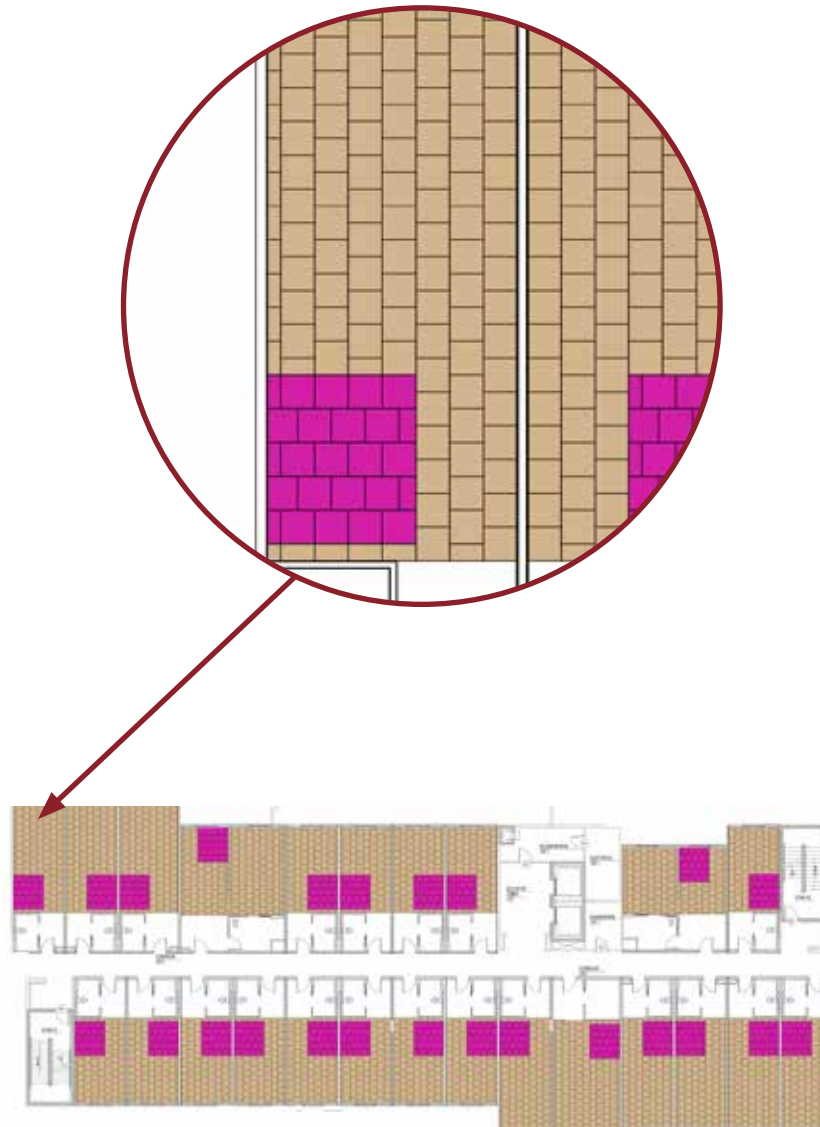

### LEGEND

A

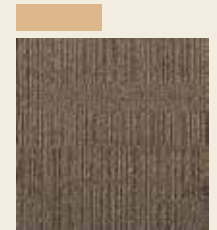

**PRODUCT:** Platform  
**ITEM:** (A) CP-03  
**COLOR:** 9332 Soapstone  
**SIZE:** 50 cm x 50 cm  
**INSTALLED:** Brick

B



**PRODUCT:** Custom  
**ITEM:** (A) CP-04  
**SAMPLE/COLOR:** 188274\_256794-176  
**SIZE:** 50 cm x 50 cm  
**INSTALLED:** Brick

## TRIBECA RECEPTION & BOARDROOM PROTOTYPE ORDER INFORMATION

Carpet tiles **SAVE APPROXIMATELY 18%-20% IN PRODUCT WASTE** versus broadloom, based on prototype layout.



PRODUCT	ITEM#	COLOR#	SAMPLE#	SIZE	INSTALLATION
<b>Reception</b> Exposed	(B) CP-01	256794-152	188434	50 cm x 50 cm	Non Directional
<b>Boardroom</b> Exposed	(B) CP-02	256794-152	188434	50 cm x 50 cm	Non Directional

INSTALLATION SPECIFICATIONS	DESCRIPTION
XL2000 PLUS Adhesive	Double stick install

## TRIBECA RECEPTION & BOARDROOM INSTALLATION PLAN

All quantities are estimates only and are based on plans provided. Site measurements and field verifications are recommended to ensure accuracy. These quantities are not intended to be used for material ordering purposes. Since waste factors may vary by installer, actual ordering quantities are the responsibility of your flooring contractor.

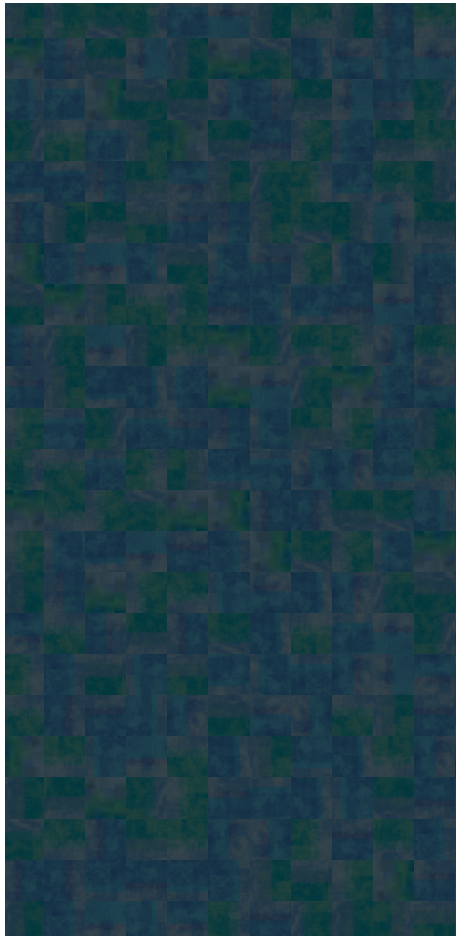

RECEPTION: (B) CP-01



BOARDROOM: (B) CP-02

### LEGEND

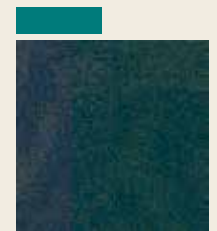

**PRODUCT:** Exposed  
**ITEMS:** (B) CP-01 & (B) CP-02  
**SAMPLE/COLOR:** 188434\_256794-152  
**SIZE:** 50 cm x 50 cm  
**INSTALLED:** Non Directional

## TRIBECA CORRIDOR PROTOTYPE ORDER INFORMATION

Carpet tiles **SAVE APPROXIMATELY 18%-20% IN PRODUCT WASTE** versus broadloom, based on prototype layout.



PRODUCT	ITEM#	COLOR#	SAMPLE#	SIZE	INSTALLATION
<b>A</b> AE311	(B) CP-02B	256794-158	188431	50 cm x 50 cm	Ashlar
<b>B</b> AE315	(B) CP-02A	256794-156	188430	50 cm x 50 cm	Ashlar
<b>C</b> AE311	(B) CP-02C	256794-164	188433	50 cm x 50 cm	Ashlar
Viva Cores 4" Carpet Base	(B) CB-01	106048 Ostra		4" x 25' Rolls	

INSTALLATION SPECIFICATIONS	DESCRIPTION
XL2000 PLUS Adhesive	Double stick install

## TRIBECA CORRIDOR INSTALLATION PLAN

All quantities are estimates only and are based on plans provided. Site measurements and field verifications are recommended to ensure accuracy. These quantities are not intended to be used for material ordering purposes. Since waste factors may vary by installer, actual ordering quantities are the responsibility of your flooring contractor.

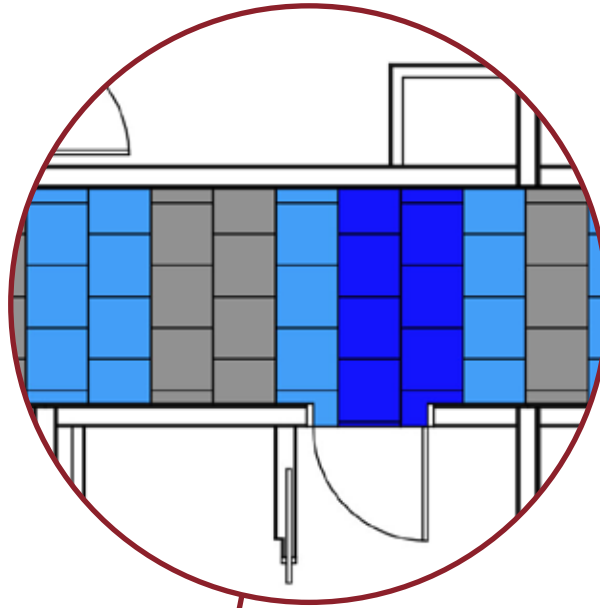

## LEGEND

A



**PRODUCT:** AE311  
**ITEM:** (B) CP-02B  
**SAMPLE/COLOR:** 188431\_256794-158  
**SIZE:** 50 cm x 50 cm  
**INSTALLED:** Ashlar

B

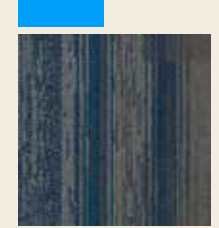

**PRODUCT:** AE315  
**ITEM:** (B) CP-02A  
**SAMPLE/COLOR:** 188430\_256794-156  
**SIZE:** 50 cm x 50 cm  
**INSTALLED:** Ashlar

C



**PRODUCT:** AE311  
**ITEM:** (B) CP-02C  
**SAMPLE/COLOR:** 188433\_256794-164  
**SIZE:** 50 cm x 50 cm  
**INSTALLED:** Ashlar

## TRIBECA GUESTROOM PROTOTYPE ORDER INFORMATION

Carpet tiles **SAVE APPROXIMATELY 18%-20% IN PRODUCT WASTE** versus broadloom, based on prototype layout.



PRODUCT	ITEM#	COLOR#	SAMPLE#	SIZE	INSTALLATION
A Platform	(B) CP-03	9332 Soapstone		50 cm x 50 cm	Brick
B Custom	(B) CP-04	256794-187	188436	50 cm x 50 cm	Brick

INSTALLATION SPECIFICATIONS	DESCRIPTION
XL2000 PLUS Adhesive	Double stick install

## TRIBECA GUESTROOM INSTALLATION PLAN

All quantities are estimates only and are based on plans provided. Site measurements and field verifications are recommended to ensure accuracy. These quantities are not intended to be used for material ordering purposes. Since waste factors may vary by installer, actual ordering quantities are the responsibility of your flooring contractor.

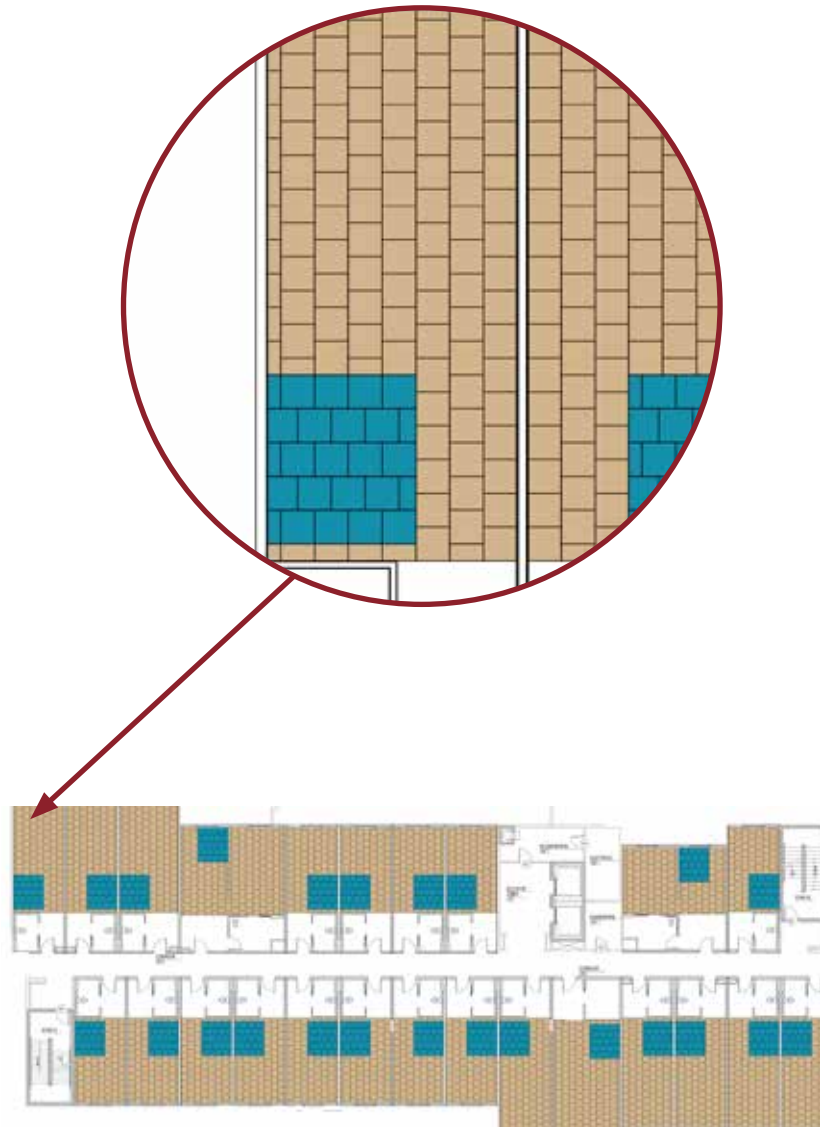

### LEGEND

A



**PRODUCT:** Platform  
**ITEM:** (B) CP-03  
**COLOR:** 9332 Soapstone  
**SIZE:** 50 cm x 50 cm  
**INSTALLED:** Brick

B



**PRODUCT:** Custom  
**ITEM:** (B) CP-04  
**SAMPLE/COLOR:** 188436\_256794-187  
**SIZE:** 50 cm x 50 cm  
**INSTALLED:** Brick