

Interface®

CAMBRIA HOTEL & SUITES



APPROVED PROTOTYPES

Cambria Hotel & Suites
Comfort Inn
Comfort Suites
Everhome Suites
Mainstay Suites
Sleep Inn

WHY INTERFACE HOSPITALITY?

Interface Hospitality is a **CHOICE HOTELS** approved supplier of carpet tile and LVT. We are currently approved on the following prototypes:

- Cambria Hotel & Suites
- Comfort Inn
- Comfort Suites
- Everhome Suites
- Mainstay Suites
- Sleep Inn



SMART, EFFICIENT, AND BUILT TO LAST

Seamless Installation & Design Flexibility

Interface modular flooring tiles are designed for effortless installation with systems like TacTiles®—our no-glue solution that reduces VOCs and waste. Choose from multiple sizes and patterns to create tailored designs that fit your needs while optimizing material usage.

Cost Efficiency, Built-In

Reduce hidden costs with modular tiles—no roll sizes, no wasteful cuts, and an average of only 3-4% waste compared to broadloom's 14%. Our selective replacement system minimizes disruption, allowing you to replace flooring in stages and save up to 50% on replacement costs.

Durability You Can Count On

Every product is backed by a 15-year warranty, combining innovative features like Intersept® mold protection and Protekt²™ stain resistance for unparalleled longevity. With modular carpet, you're investing in a solution that performs and saves in the long run.



DESIGNED FOR PERFORMANCE AND PEOPLE

Innovative Fibers for Vibrant, Sustainable Style

All Interface carpet tiles are made from 100% solution-dyed nylon—engineered for vibrant, fade-resistant color without the need for water or harmful chemicals in production.

The Power of Integrated Systems

Interface tiles span a variety of sizes and textures, enabling endless creative possibilities. Our modular designs seamlessly integrate with LVT for holistic flooring solutions without transition strips, redefining design flexibility.

Health-Conscious Choices

Our Intersept[®] treatment guarantees mold protection and uses no halogens, heavy metals, or harmful chemicals. It's EPA-approved for safe use, ensuring healthier spaces for your guests and teams.

SUSTAINABILITY & END-OF-LIFE SOLUTIONS

Transparency at Every Step

Sustainability comes standard. With third-party certifications and 99% renewable energy powering our U.S. manufacturing, Interface delivers flooring that's both high-performing and environmentally conscious.

Recycling Made Simple with ReEntry[®]

Through ReEntry[®], we reclaim and recycle used carpet tiles and Sound Choice[™] LVT, keeping valuable materials out of landfills. As North America's only third-party-certified flooring recycling program, we set the benchmark for responsible end-of-life solutions.

Smarter Installations for a Smaller Footprint

TacTiles[®] eliminate the need for adhesives with carpet tiles, cutting installation waste by 90%. Combined with modular flooring's reduced waste profile, this innovation ensures your project leaves a lighter environmental footprint.

CORRIDOR PROTOTYPE ORDER INFORMATION - OPTION 1

Carpet tiles **SAVE APPROXIMATELY 18%-20% IN PRODUCT WASTE** versus broadloom, based on prototype layout.

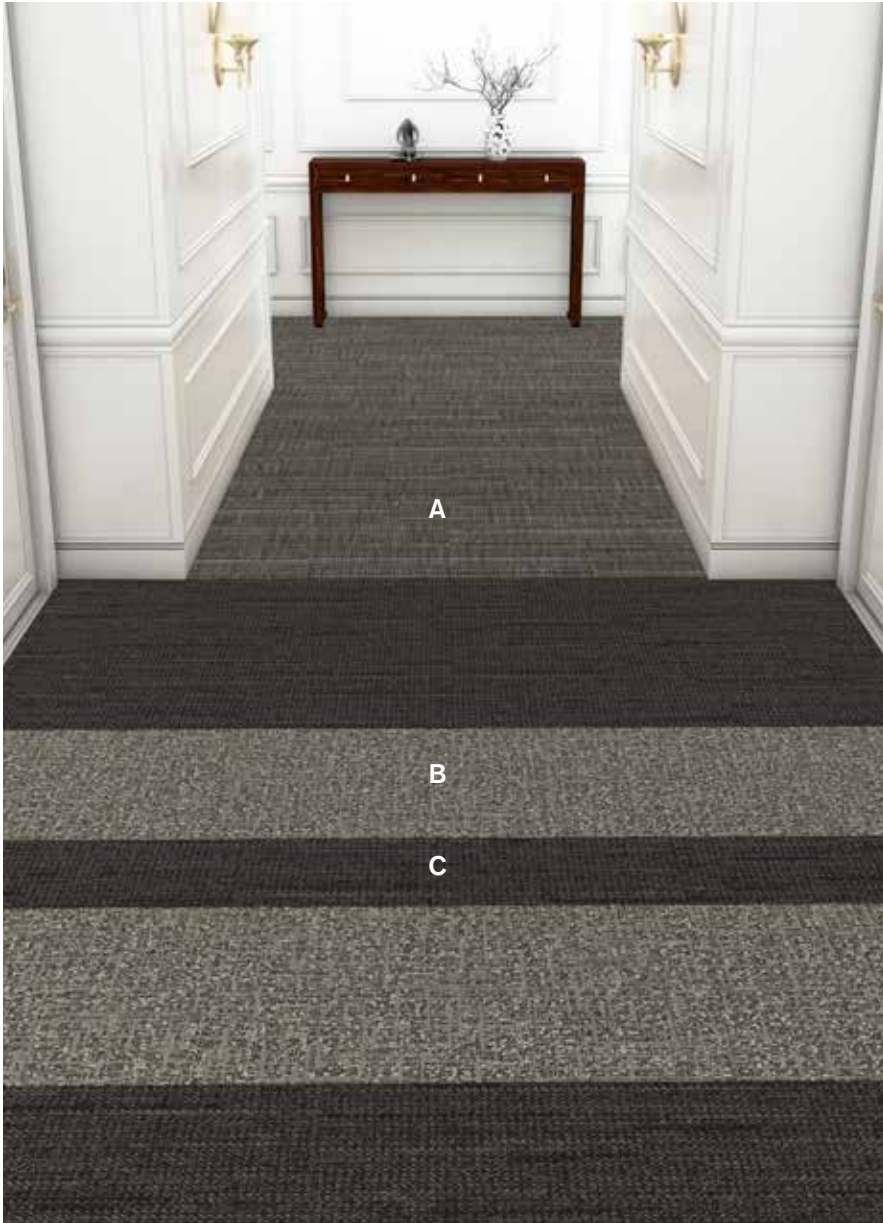

PRODUCT	COLOR#	SIZE	INSTALLATION
A French Seams	105606 Cannes	25 cm x 1 m	Ashlar
B WW890	105388 Natural Dobby	25 cm x 1 m	Ashlar
C WW870	105347 Brown Weft	25 cm x 1 m	Ashlar

INSTALLATION SPECIFICATIONS	DESCRIPTION
XL2000 PLUS Adhesive	Double stick install

CORRIDOR INSTALLATION PLAN - OPTION 1

All quantities are estimates only and are based on plans provided. Site measurements and field verifications are recommended to ensure accuracy. These quantities are not intended to be used for material ordering purposes. Since waste factors may vary by installer, actual ordering quantities are the responsibility of your flooring contractor.

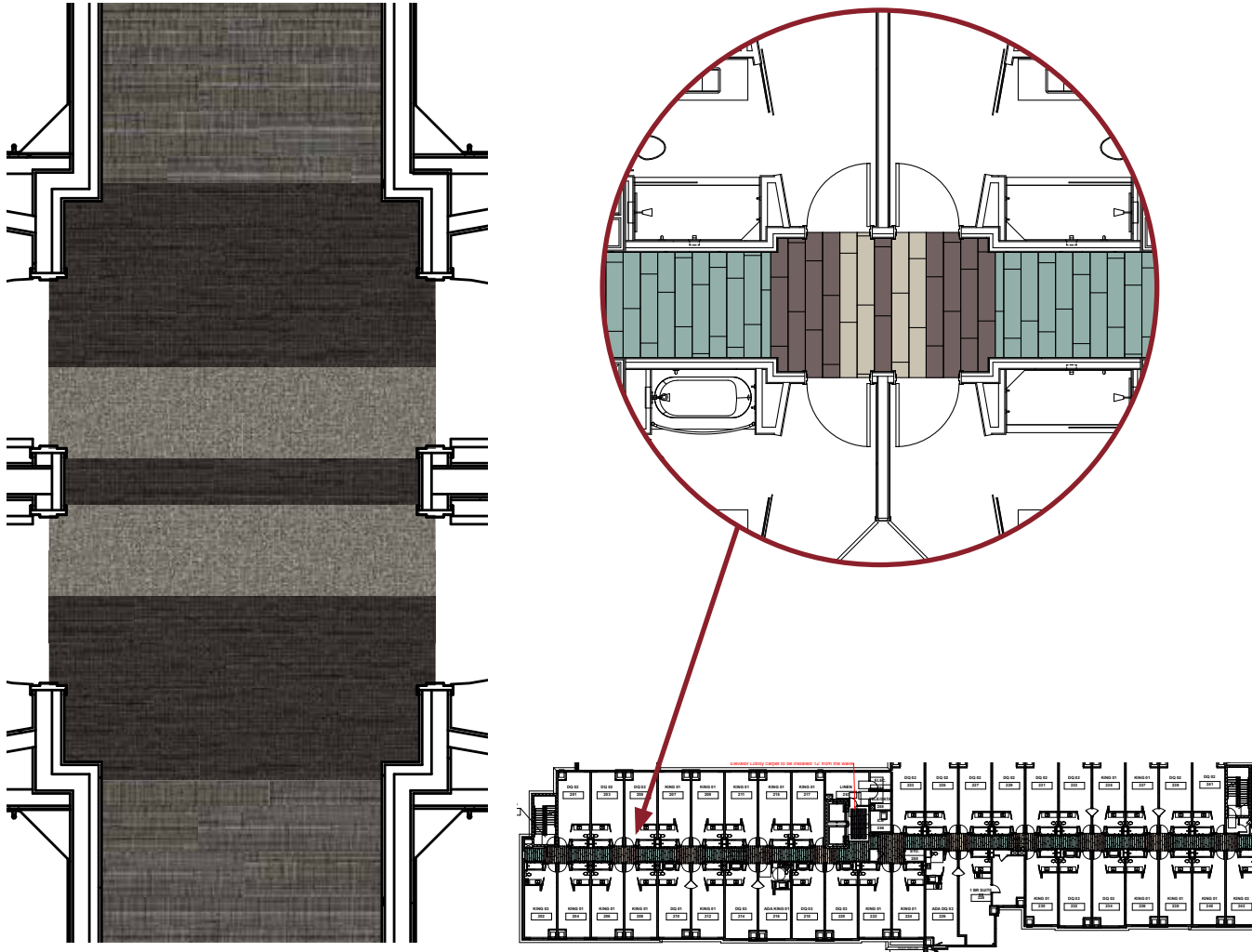

LEGEND

A



PRODUCT: French Seams
COLOR: 105606 Cannes
SIZE: 25 cm x 1 m
INSTALLED: Ashlar

B



PRODUCT: WW890
COLOR: 105388
 Natural Dobby
SIZE: 25 cm x 1 m
INSTALLED: Ashlar

C



PRODUCT: WW870
COLOR: 105347
 Brown Weft
SIZE: 25 cm x 1 m
INSTALLED: Ashlar

CORRIDOR PROTOTYPE ORDER INFORMATION - OPTION 2

Carpet tiles **SAVE APPROXIMATELY 18%-20% IN PRODUCT WASTE** versus broadloom, based on prototype layout.



PRODUCT	COLOR#	SIZE	INSTALLATION
A French Seams	105606 Cannes	25 cm x 1 m	Ashlar
B WW890	105388 Natural Dobby	25 cm x 1 m	Pattern by Tile
C WW870	105347 Brown Weft	25 cm x 1 m	Pattern by Tile

INSTALLATION SPECIFICATIONS	DESCRIPTION
XL2000 PLUS Adhesive	Double stick install

CORRIDOR INSTALLATION PLAN - OPTION 2

All quantities are estimates only and are based on plans provided. Site measurements and field verifications are recommended to ensure accuracy. These quantities are not intended to be used for material ordering purposes. Since waste factors may vary by installer, actual ordering quantities are the responsibility of your flooring contractor.

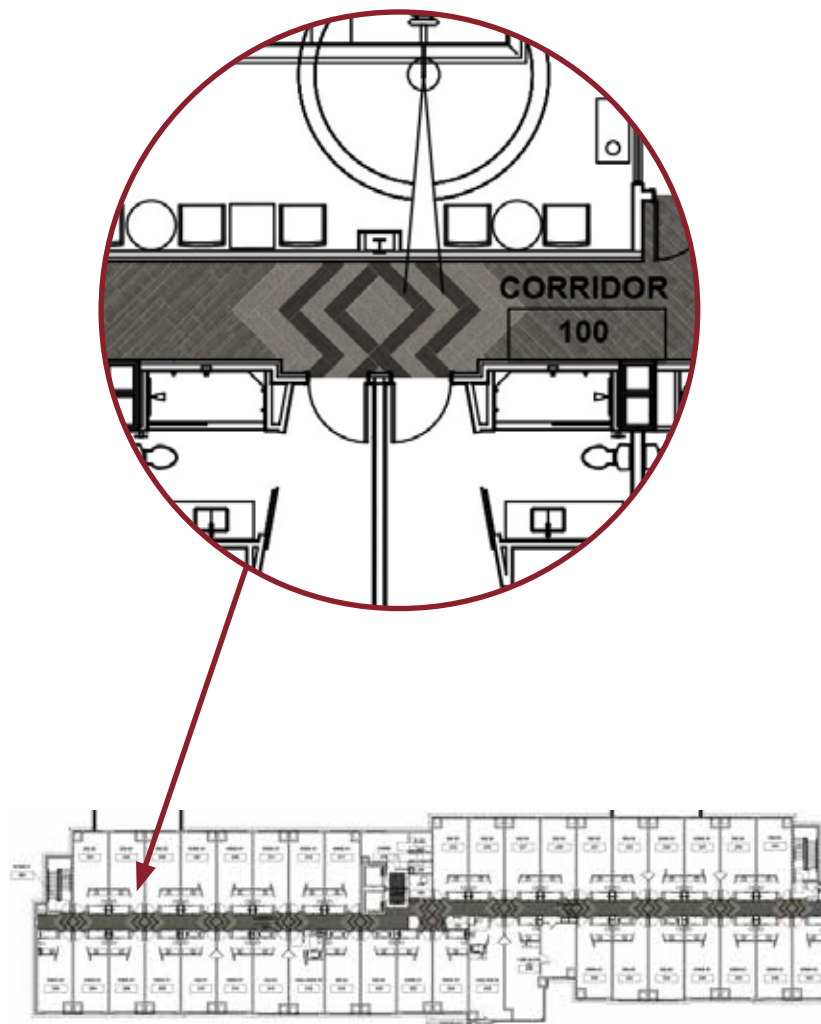

LEGEND

A



PRODUCT: French Seams
COLOR: 105606 Cannes
SIZE: 25 cm x 1 m
INSTALLED: Ashlar

B



PRODUCT: WW890
COLOR: 105388
Natural Dobby
SIZE: 25 cm x 1 m
INSTALLED: Pattern by Tile

C



PRODUCT: WW870
COLOR: 105347
Brown Weft
SIZE: 25 cm x 1 m
INSTALLED: Pattern by Tile

ELEVATOR LOBBY PROTOTYPE ORDER INFORMATION

Carpet tiles **SAVE APPROXIMATELY 18%-20% IN PRODUCT WASTE** versus broadloom, based on prototype layout.



PRODUCT	ITEM#	COLOR#	SIZE	INSTALLATION
HN840	CP-03	104223 Slate	25 cm x 1 m	Ashlar

INSTALLATION SPECIFICATIONS	DESCRIPTION
XL2000 PLUS Adhesive	Double stick install

ELEVATOR LOBBY INSTALLATION PLAN

All quantities are estimates only and are based on plans provided. Site measurements and field verifications are recommended to ensure accuracy. These quantities are not intended to be used for material ordering purposes. Since waste factors may vary by installer, actual ordering quantities are the responsibility of your flooring contractor.

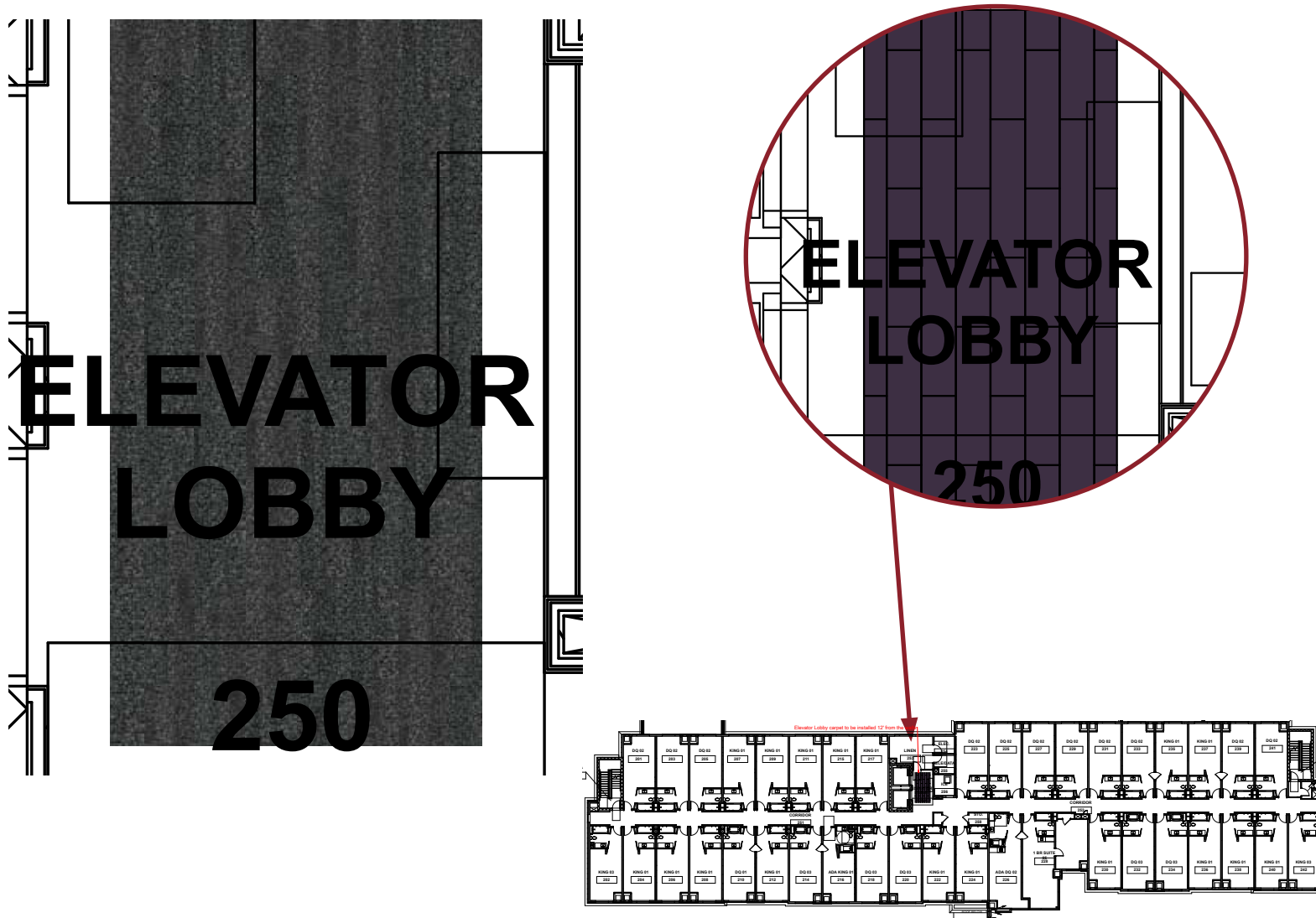

LEGEND



PRODUCT: HN840
ITEM: CP-03
COLOR: 104223 Slate
SIZE: 25 cm x 1 m
INSTALLED: Ashlar

MEETING ROOM PROTOTYPE ORDER INFORMATION

Carpet tiles **SAVE APPROXIMATELY 18%-20% IN PRODUCT WASTE** versus broadloom, based on prototype layout.



PRODUCT	ITEM#	COLOR#	SIZE	INSTALLATION
A WW895	CP-07	105378 Moorland Weave	25 cm x 1 m	Pattern by Tile
B B701	CP-07	102893 Caspian	25 cm x 1 m	Pattern by Tile
C B702	CP-07	102901 Caspian	25 cm x 1 m	Pattern by Tile
D B702	CP-07	102896 Black Sea	25 cm x 1 m	Pattern by Tile
Viva Colores 4" Carpet Base	CB-02	101178 Carbon	4" x 25' Rolls	

INSTALLATION SPECIFICATIONS	DESCRIPTION
XL2000 PLUS Adhesive	Double stick install

MEETING ROOM INSTALLATION PLAN

All quantities are estimates only and are based on plans provided. Site measurements and field verifications are recommended to ensure accuracy. These quantities are not intended to be used for material ordering purposes. Since waste factors may vary by installer, actual ordering quantities are the responsibility of your flooring contractor.

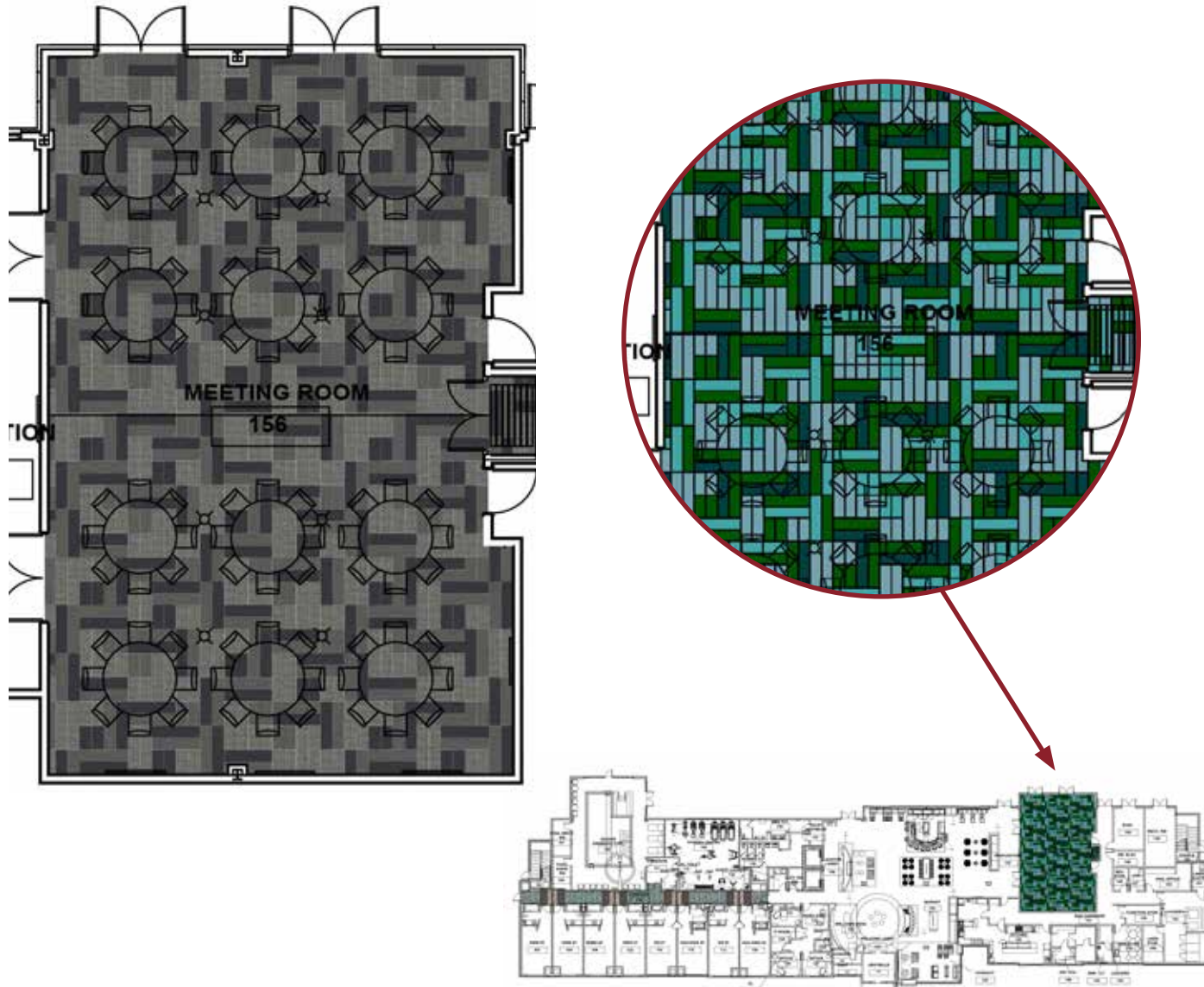

LEGEND

A



PRODUCT: WW895
ITEM: CP-07
COLOR: 105378
 Moorland Weave
SIZE: 25 cm x 1 m
INSTALLED: Pattern by Tile

B



PRODUCT: B701
ITEM: CP-07
COLOR: 102893 Caspian
SIZE: 25 cm x 1 m
INSTALLED: Pattern by Tile

C



PRODUCT: B702
ITEM: CP-07
COLOR: 102901 Caspian
SIZE: 25 cm x 1 m
INSTALLED: Pattern by Tile

D



PRODUCT: B702
ITEM: CP-07
COLOR: 102896 Black Sea
SIZE: 25 cm x 1 m
INSTALLED: Pattern by Tile